

Control Valve Solenoid 2-Way Pilot Operated



Sizes 3/8" / 10 mm

Flomatic Corporation

Material (Brass)

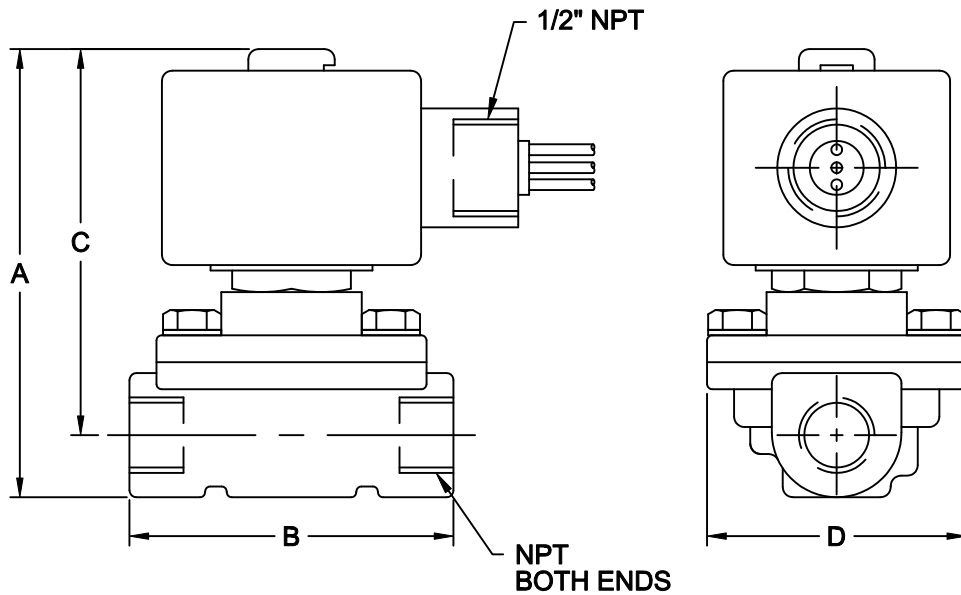

VALVE PARTS IN CONTACT WITH FLUIDS

- BODY - BRASS
- SEALS & DISCS - BUNA-N
- DISC HOLDER - NYLON
- CORE TUBE - 305 S.S.
- CORE & PLUGNUT - 430F S.S.
- SPRINGS - 302 S.S.
- SHADING COIL - COPPER

120 VOLT AC
 WATT RATING:17.1
 CLASS OF COIL INSULATION:F
 ORIFICE: 5/8
 NORMALLY CLOSED WHEN DE-ENERGIZED

APPROVALS
 CSA CERTIFIED
 UL LISTED

Dimensions

| Size | | Part # | A | | B | | C | | D | |
|------|----|--------|---------|----|-------|----|---------|----|--------|----|
| Inch | mm | | Inch | mm | Inch | mm | Inch | mm | Inch | mm |
| 3/8 | 10 | 8858 | 3-29/32 | 99 | 2-3/4 | 70 | 3-11/32 | 85 | 2-5/16 | 59 |

Flomatic Corporation can accept no responsibility for possible errors in catalogues, brochures and other printed material. Flomatic Corporation reserves the right to alter its products without notices. This also applies to product already agreed. All trademarks in this material are property of the respective companies. All right reserved. ©2011 Flomatic Corporation. The drawings & information on this drawing sheet are the sole & exclusive property of Flomatic Corporation. Any reproduction, distribution, display or use of these drawings or information in whole or in part without written authorization of Flomatic Corporation is strictly prohibited.



July 8, 2003
 Dwg No: SASCO7 Rev A (6/11)

FLOMATIC CORPORATION
 GLENS FALLS, N.Y. 12801
 PHONE (518) 761-9797
 FAX (518) 761-9798