

# Control Valve Solenoid 2-Way Pilot Operated



Sizes 3/8" / 10 mm

Flomatic Corporation

## Material (Brass)

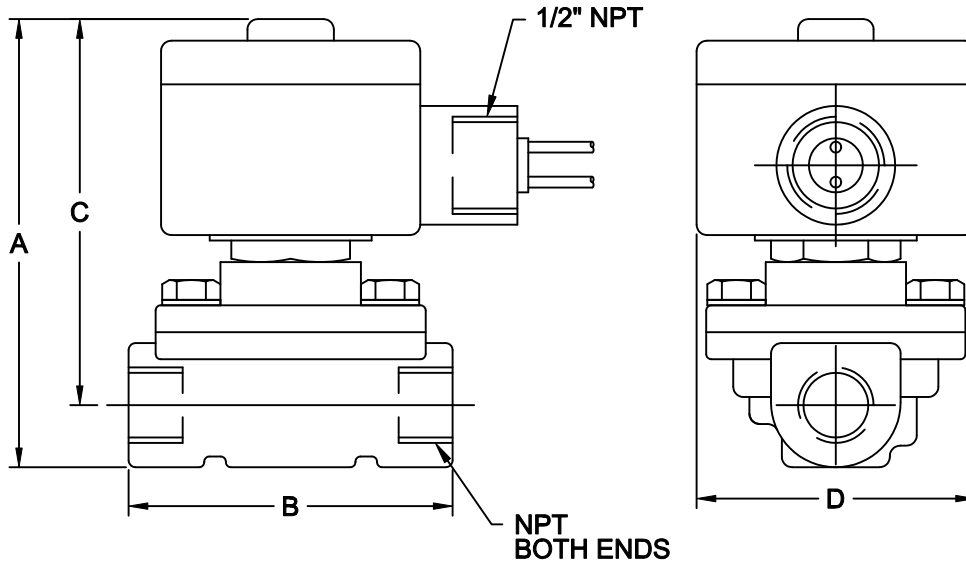

### VALVE PARTS IN CONTACT WITH FLUIDS

BODY - BRASS

SEALS & DISCS - BUNA-N

DISC HOLDER - NYLON

CORE TUBE - 305 S.S.

CORE & PLUGNUT - 430F S.S.

SPRINGS - 302 S.S.

SHADING COIL - COPPER

120 VOLT AC

WATT RATING:10.1

CLASS OF COIL INSULATION:F

ORIFICE: 5/8

NORMALLY OPEN WHEN DE-ENERGIZED

EXPLOSION PROOF SOLENOID ENCLOSURE

### APPROVALS

CSA CERTIFIED

## Dimensions

Size		Part #	A		B		C		D	
Inch	mm		Inch	mm	Inch	mm	Inch	mm	Inch	mm
3/8	10	8855	4-3/4	121	2-3/4	70	3-15/16	100	2-3/8	60

Flomatic Corporation can accept no responsibility for possible errors in catalogues, brochures and other printed material. Flomatic Corporation reserves the right to alter its products without notices. This also applies to product already agreed. All trademarks in this material are property of the respective companies. All right reserved. ©2011 Flomatic Corporation. The drawings & information on this drawing sheet are the sole & exclusive property of Flomatic Corporation. Any reproduction, distribution, display or use of these drawings or information in whole or in part without written authorization of Flomatic Corporation is strictly prohibited.



July 8, 2003  
Dwg No: SASCO8 Rev A (6/11)

FLOMATIC CORPORATION  
GLENS FALLS, N.Y. 12801  
PHONE (518) 761-9797  
FAX (518) 761-9798