

Model 115MJ

Sizes: 2½" - 16"

Mechanical Joint x Mechanical Joint



**FEATURES:**

**Sizes:** □ 2 ½" □ 3" □ 4" □ 6" □ 8"  
 □ 10" □ 12" □ 16"

Max. working water pressure 250 PSI (1723 kPa)  
 Max. working water temperature 140°F (60°C)  
 Hydrostatic test pressure 400 PSI (2758 kPa)  
 End connection AWWA C111/A21.1  
 Optional hand wheel add "HW" to end of part #  
 Opens Left turn

**STANDARDS COMPLIANCE:**

- AWWA Compliant C-515

**MATERIALS:**

Valve Body & Covers Ductile Iron ASTM A536 Gr 65-45-12  
 Coating AWWA compliant C-550 & FDA Compliant (Inside & Out)  
 Wedge Ductile Iron ASTM A536 Gr 65-45-12 With EPDM coating  
 Elastomers EPDM FDA approved  
 Fasteners Zinc plated steel ASTM A307 Grade B & 304 Stainless Steel  
 Stem 420 Stainless Steel

**APPLICATION:**

Designed for installation on potable water lines, irrigation systems, waterworks connections and fire systems.

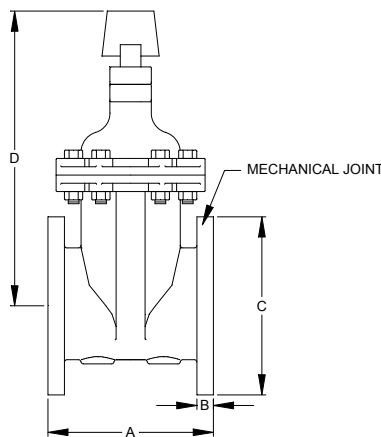

Size		Part #	A		B		C		D		WEIGHT	
Inch	mm		Inch	mm	Inch	mm	Inch	mm	Inch	mm	lbs	kg
2-1/2	65	8561MJ	7-1/2	191	11/16	18	7	178	11-9/64	283	42	19
3	80	8562MJ	8	203	3/4	19	7-1/2	191	12-1/2	316	44	20
4	100	8563MJ	9	229	15/16	24	9	229	13-11/32	339	69	31
6	150	8564MJ	10-1/2	267	1	25	11	279	16-9/16	421	119	54
8	200	8565MJ	11-1/2	292	1-1/8	29	13-1/2	343	20-3/4	527	203	92
10	250	8566MJ	13	330	1-3/16	30	16	406	24-11/32	618	278	126
12	300	8567MJ	14	356	1-1/4	32	19	483	27-9/16	700	421	191
16	400	8569MJ	16	406	1-19/64	33	23-1/2	597	49-1/4	1252	656	298

**WARRANTY:** Flomatic valves are guaranteed against defects of materials or workmanship when used for the services recommended. If in any recommended service, a defect develops due to material or workmanship, and the device is returned, freight prepaid, to Flomatic Corporation within 12 months from the date of purchase, it will be repaired or replaced free of charge. Flomatic Corporations' liability shall be limited to our agreement to repair or replace the valve only.