

BREAK-OFF PLUGS

MODELS PLG AND PPLG

FOR SUBMERSIBLE PUMP CHECK VALVES

Designed to drain well water in the riser pipe when the submersible pump is pulled for service. Fromatic Break-Off Plugs are available on Model 80DI, 80DIVFD, 80DIX, 80S6, 80S6VFD, 80DICLVFD, and 80S6CLVFD in a size range from 2" thru 12".



The weight of the pipe is reduced between 25% - 50% when the break-off plug is used and the water is drained.

PRODUCT SPECIFICATIONS

- For 2" valve size plug threads are 1/8"
- For 2 1/2" - 6" plug threads are 3/8"
- For 8" - 12" plug threads: 1/2" NPT connection

FEATURES & BENEFITS

- Simple construction
- Field proven design
- Stainless Steel or Composite design
- Easily field replaceable
- Less weight when pulling the pump
Smaller equipment required
- Faster pump pulling & servicing

APPLICATIONS

- Domestic Water Well systems
- Municipal Well Water systems
- Irrigation and Sprinkler systems

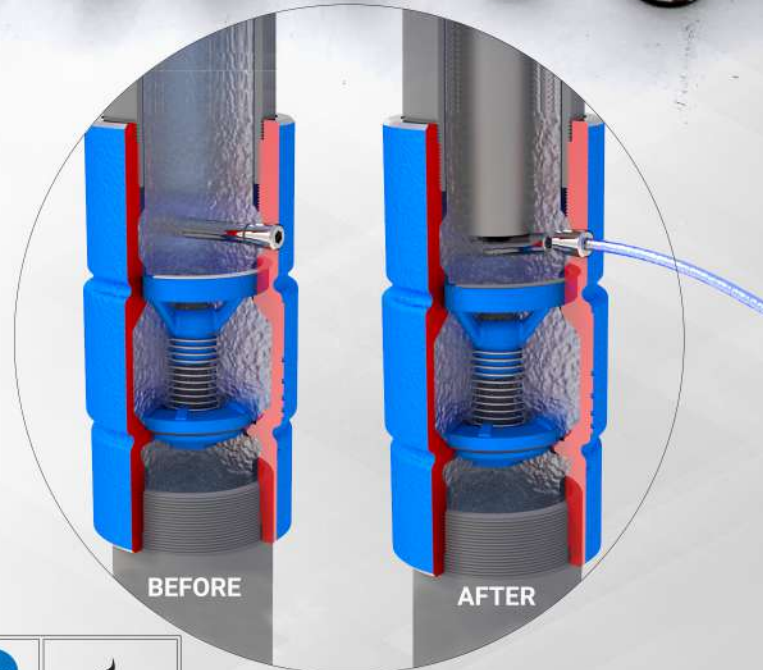

FLOMATIC® VALVES

High Quality Valves Built To Last...

OPERATION EXAMPLE

100 feet of 6" riser pipe has a total weight (pipe and water weight) of approximately 3,150 lbs.

By using a Fromatic check valve with a break-off plug, this weight can be reduced by 1,250 lbs. or by nearly 40%.

This greatly simplifies pulling the riser pipe and submersible pump for servicing. In addition, 150 less gallons per 100 foot of pipe will be spilled on the surface.

- A. Reduces the lifting weight: By 25 % to 50 %.
- B. Eliminates water splashing at the surface.
- C. Simply replace the break-off plug for re-installation.



STAINLESS STEEL



COMPOSITE

Using the example above; in a 6" riser pipe a 3" pipe four feet long would be used to snap the break-off plug. See Chart Below.

- A. Drop a length of pipe down the riser pipe.
- B. The break-off plug breaks allowing the riser pipe to drain.

Valve Size		Part # 304 Stainless Steel	Part # Nylon	NPT Size	A		B		Break-Off Pipe			
inch	mm				inch	mm	inch	mm	Size		Length	
					inch	mm	inch	mm	inch	mm	feet	meters
2	50	76098-2	N/A	1/8	2	50	7/32	6	1"	25	10	3
2-1/2	65	76098-3	76098P	3/8	2-1/2	65	5/16	8	1-1/2	40	10	3
3	75	76098-6	76098P	3/8	3	75	5/16	8	1-1/2	40	10	3
4	100	76098-7	76098P	3/8	4	100	5/16	8	2	50	10	3
5	125	76098	76098P	3/8	5	125	5/16	8	2-1/2	65	10	3
6	150	76098	76098P	3/8	5	125	5/16	8	3	80	4	1.2
8	200	76098	76098P	3/8	5	125	5/16	8	4	100	4	1.2
8	200	76098-8	N/A	1/2	5	125	1/2	50	4	100	4	1.2
10	250	76098-11	N/A	1/2	8-1/2	206	1/2	50	5	125	4	1.2
12	300	76098-11	N/A	1/2	8-1/2	206	1/2	50	5	125	4	1.2

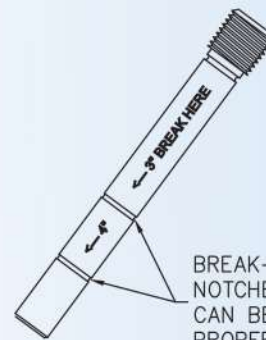
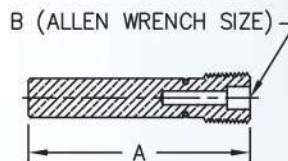
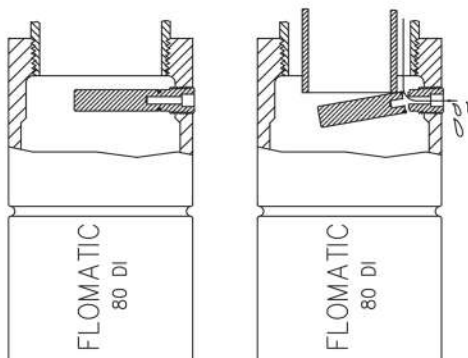

BREAK-OFF PLUG NOTCHED SO IT CAN BE CUT TO THE PROPER VALVE SIZE



WWW.FLOMATIC.COM

15 Pruy'n's Island, Glens Falls NY 12801 | 518-761-9797